

# Quick-Click™ LC Cleaner Instruction Manual

Thank you for choosing the **Quick-Click™ LC Cleaner**. The **Quick-Click™ LC Cleaner** is a high-performance device designed for cleaning the ferrule end faces of LC connectors and MU connectors. Carefully read this instruction manual before using this device. Please keep this instruction manual for future reference.

## 1. Safety precautions



Though our device is deemed safe, improper usage or handling can still inflict injury to others.

Quick-Click LC Cleaner is designed to clean LC connectors and MU connectors only. PRO is not liable for damage caused in attempt to apply this device to other applications.

## 2. Notes on usage

- Do not attempt to disassemble as this can cause damage to the device.
- Do not re-use cleaning cloth as this will eliminate its cleaning ability.
- Do not touch the cleaning cloth as this will cause contamination.
- Do not pull the cleaning cloth, use only the device body.
- Do not use this cleaner when the cloth is empty, as this can cause damage to the connector.

## 3. Notes on storage for extended periods

- Do not expose device to direct sunlight, high temperature or high humidity.
- The cover on the guide cap should be closed at all times when device is not in use.

## 4. Sales enquiries

Precision Rated Optics  
Tel : (888) 545-1254  
E-mail : Sales@FiberOpticPro.com  
Website : www.fiberopticpro.com

## 5. Device construction

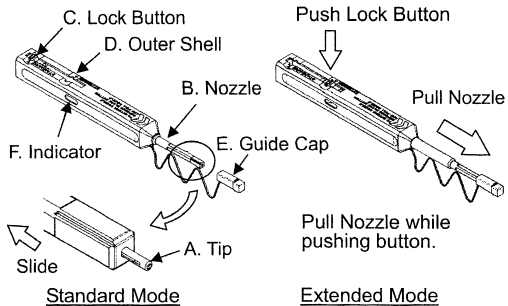

	View of Indicator	View of the Nozzle end
Full	Cloth (White)	Tip (Black) Cloth (White)
Little	Cloth (White) Red	Cloth (White)
Empty	Red	Tip (Black) No Cloth (Black)

Identification of remaining cloth

No.	Part Name	Function
A	Tip	Lead the cleaning cloth to the optical connector end face.
B	Nozzle	Lead tip to the optical connector end face.
C	Lock Button	Push the button to extend and contract the nozzle.
D	Outer Shell	Push the outer shell to clean the connector.
E	Guide Cap	Acts as dust cap or cleaning adapter for connector plug.
F	Indicator	Provides indication of remaining cleaning cloth.

## 6. Applications

### <Connector inside adaptor>

1. Remove Guide Cap from the device

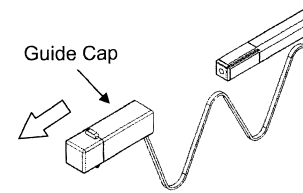

2. Insert tip of cleaner into LC Adaptor

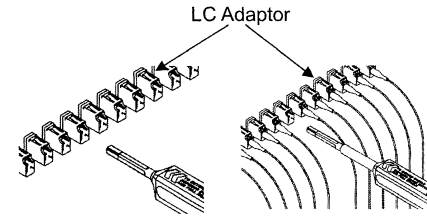

Standard Mode

Extended Mode

Note: This drawing shows only LC, but this product can clean MU too.

3. Push the Outer Shell to start cleaning the LC connector end face. A "click" sound indicates end of cleaning process. Close the cover after use.

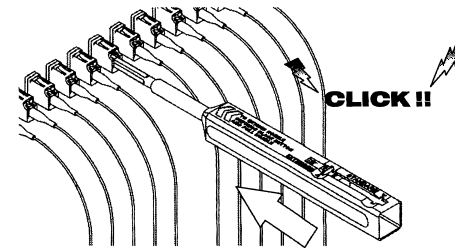

Be careful not to slant the Quick-Click LC Cleaner while inserting into the adaptor.

Do not overly exert force during insertion as this may cause damage to both the connector and the Quick-Click LC Cleaner

If pushing Outer Shell is inhibited, remove Quick-Click LC Cleaner from adaptor and ensure that there is no sizeable debris inhibiting the cleaning process.

### <Connector plugs alone>

1. Open the Cover on the Guide Cap

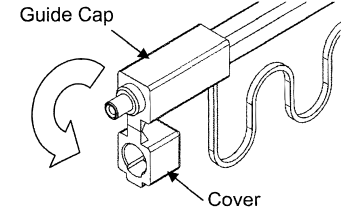

2. Insert LC connector into the Guide Cap

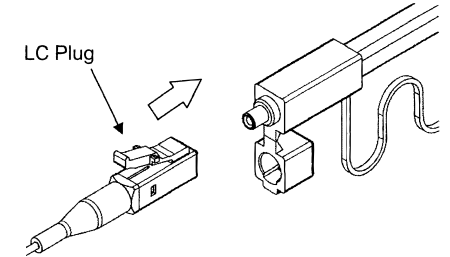

Note: This drawing shows only LC, but this product can clean MU too.

3. Push the Outer Shell to start cleaning the LC connector end face. A "click" sound indicates end of cleaning process. Close the cover after use.

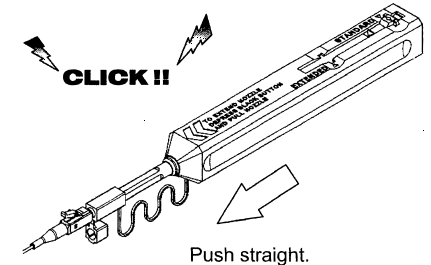

Be careful not to slant LC connector while inserting into the Guide cap.

Do not overly exert force during insertion as this may cause damage to both the connector and the Quick-Click LC Cleaner

If pushing Outer Shell is inhibited, remove Quick-Click LC Cleaner from adaptor and ensure that there is no sizeable debris inhibiting the cleaning process.